

### ⚠ WARNING

#### DOs

- ✓ Use each pad in **only a single session** (one practice).
- ✓ Avoid unnecessary extended exposure to air.
- ✓ Keep the pad away from high temperature, high humidity and direct sunlight.

#### DON'Ts

- ✓ Do not open the package until just before a practice.
- ✓ Do not keep the tubes (vein/ artery) filled with water.
- ✓ Do not leave any water on the pad.



1. Open the CVC pad.



**⚠ WARNING**  
Do not open the lid for "ultrasound use."

1. Remove the lid behind the pad to become a landmark puncture pad.

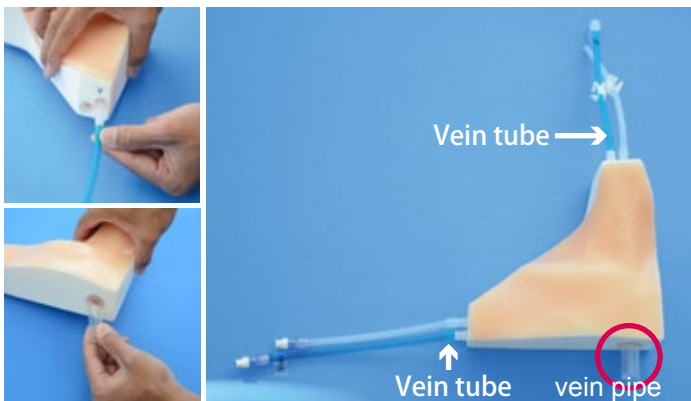

2. Connect the four tubes and a vein pipe to the CVC pad.

When attaching the vein pipe, please do not screw the pipe.



3. Connect the 50ml syringe to the tube and slowly inject with 50ml syringe twice (100ml of water) while raising the edge of the body to fill the tubes with liquid.



#### Temporary storage method

If you open the package by mistake;

This is a temporary measure only.

1. Apply the film tightly against the surface, to make sure there is no space or air trapped to cause evaporation of material moisture.
2. Put the pad in its case.
3. Store it in a sealed container or in an airtight bag that can be sealed.

2016/02/23